

FRANKLIN Valve

High Integrity, Double Block and Bleed Plug Valve

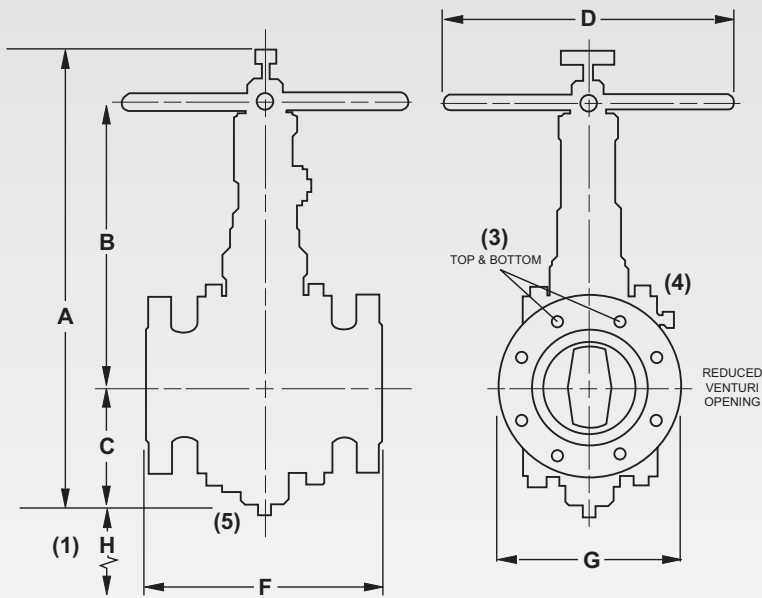

TYPICAL HAND OPERATED VALVE

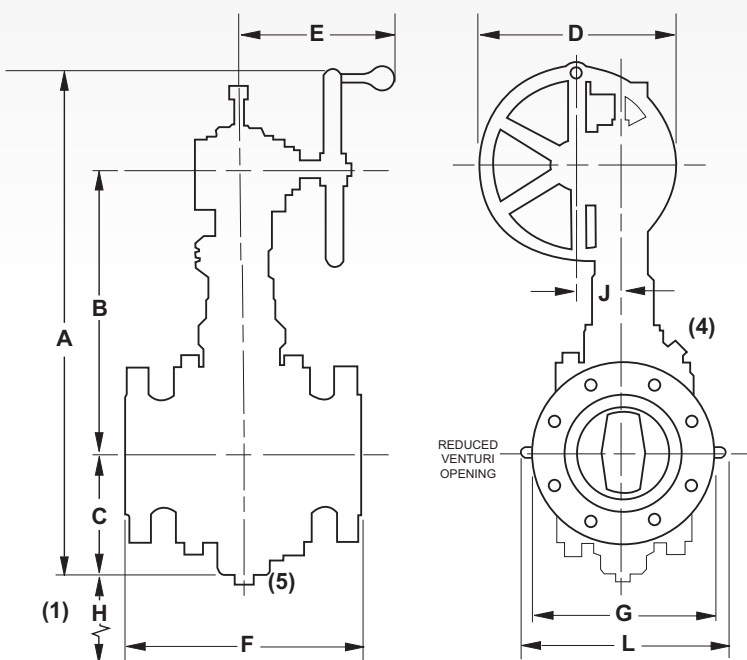

TYPICAL GEAR OPERATED VALVE

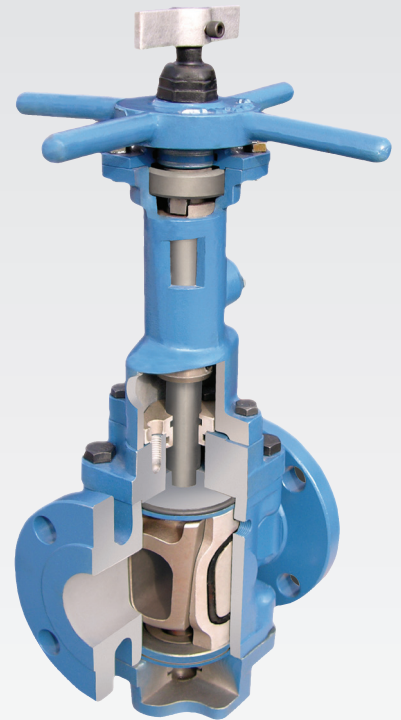

FRANKLIN VALVE

7720 Bluff Point Rd.

Houston, TX 77086

www.franklinvalve.com

sales@franklinvalve.com

Phone: 713.812.7100

Fax: 713.686.5158



TYPICAL HAND OPERATED VALVE

CLASS	SIZE	MODEL	OPER.	A	B	C	D	F	G	H	WEIGHT(lbs)	(3)	(4)	(5)
ANSI 150	2	D711	100	17	11	4 ½	10	7	6	3	48	NONE	3/8 NPT	1/4 NPT
	3	D711	100	17	11	4 ½	10	8	7 ½	3	62	NONE	3/8 NPT	1/4 NPT
	4	D711	200	27	16	7	20	9	9	4 ½	132	NONE	1/2 NPT	1/4 NPT
	6	D711	200	32 ½	20 ½	9	20	10 ½	11	8	214	(4) ¾" 10 UNC	1/2 NPT	1/4 NPT
	8	D711	300	36	22	10 ½	20	11 ½	13 ½	11	388	(4) ¾" 10 UNC	1/2 NPT	1/4 NPT
ANSI 300	2	D721	100	17	11	4 ½	10	8 ½	6 ½	3	54	NONE	3/8 NPT	1/4 NPT
	3	D721	100	17	11	4 ½	10	11 ⅛	8 ¼	3	76	NONE	3/8 NPT	1/4 NPT
	4	D721	200	27	16	7	20	12	10	5	158	NONE	1/2 NPT	1/4 NPT
	6	D721	300	32 ½	20 ½	9	20	15 ⅞	12 ½	8	318	NONE	1/2 NPT	1/4 NPT
ANSI 600	2	D741	200	24 ½	15 ½	15 ½	20	11 ½	6 ½	2 ½	100	NONE	1/2 NPT	1/4 NPT
	3	D741	200	26	16	16	20	14	8 ¼	3 ½	142	NONE	1/2 NPT	1/4 NPT
	4	D741	300	29 ½	19	19	20	17	10 ¾	4	230	NONE	1/2 NPT	1/4 NPT

(1) H-Minimum clearance required to replace slips.
 (3) Number and size tapped holes. Each flange.

(4) Tapped bleeder hole.
 (5) Bottom plate drain hole.

Dimensions "F" & "G" are nominal.
 All others are rounded off to the nearest half-inch.

TYPICAL GEAR OPERATED VALVE

	SIZE	MODEL	OPER.	A	B	C	D	E	F	G	H	J	WEIGHT(lbs)	(3)	(4)	(5)
ANSI 150	2	D711	101	21	12	4 ½	8	10 ½	7	6	3	1 ½	64	NONE	3/8 NPT	1/4 NPT
	3	D711	101	21	12	4 ½	8	10 ½	8	7 ½	3	1 ½	76	NONE	3/8 NPT	1/4 NPT
	4	D711	201	27	15 ½	7	10	11	9	9	4 ½	1 ¾	140	NONE	1/2 NPT	1/4 NPT
	6	DA711	301	36	20 ½	8 ½	14	12 ½	10 ½	11	8	3	264	(4) ¾" 10 UNC	1/2 NPT	1/4 NPT
	8	D711	301	39 ½	22	10 ½	14	12 ½	11 ½	13 ½	11	3	436	(4) ¾" 10 UNC	1/2 NPT	1/4 NPT
	10	D711	301	42	23	12	14	12 ½	13	16	14	3	532	(4) 7/8" 9 UNC	1/2 NPT	1/4 NPT
	12	D711	401	55 ½	31	14 ½	20	12 ½	14	19	16	3 ½	844	(4) 7/8" 9 UNC	1/2 NPT	1/4 NPT
	16	D711	501	67	39	18	20	14 ½	16	23 ½	21	5	1488	(8) 1" 8 UNC	1/2 NPT	1/2 NPT
	20*	D711	501	64	37	17	20	14 ½	40	27 ½	17	5	3326	NONE	1 NPT	1/4 NPT
	24*	D711	501	78 ½	44	24 ½	20	14 ½	48	32	20	5	6264	NONE	1 NPT	1 NPT
ANSI 300	2	D721	101	21	12	4 ½	8	10 ½	8 ½	6 ½	3	1 ½	78	NONE	3/8 NPT	1/4 NPT
	3	D721	101	21	12	4 ½	8	10 ½	11 ⅛	8 ¼	3	1 ½	102	NONE	3/8 NPT	1/4 NPT
	4	D721	201	27	15 ½	7	10	11	12	10	4 ½	1 ¾	162	NONE	1/2 NPT	1/4 NPT
	6	D721	301	36	20 ½	8 ½	14	12 ½	15 ⅞	12 ½	8	3	348	NONE	1/2 NPT	1/4 NPT
	8	D721	401	49 ½	28	11	20	12 ½	16 ½	15	11	3 ½	666	(4) 7/8" - 9 UNC	1/2 NPT	1/4 NPT
	10	D721	401	52	29	12 ½	20	12 ½	18	17 ½	13	3 ½	888	(4) 1" - 8 UNC	1/2 NPT	1/4 NPT
ANSI 600	2	D741	201	24 ½	15 ½	15 ½	20	10 ½	11 ½	6 ½	2 ½	1 ½	100	NONE	1/2 NPT	1/4 NPT
	3	D741	201	26	16	16	20	10 ½	14	8 ¼	3 ½	1 ½	142	NONE	1/2 NPT	1/4 NPT
	4	D741	301	29 ½	19	19	20	11	17	10 ¾	4	1 ¾	230	NONE	1/2 NPT	1/4 NPT
	6	D741	401	45	26	9	20	12 ½	22	14	10	3 ½	696	NONE	1/2 NPT	1/4 NPT
	8	D741	401	48	27	11	20	13 ½	26	16 ½	12	5	1102	NONE	1/2 NPT	1/4 NPT
	10	D741	501	62 ½	36 ½	16	20	14 ½	31	20	8	5	1974	NONE	1/2 NPT	1/2 NPT
12	D741	501	62 ½	38	17	20	14 ½	33	22	10	5	2532	NONE	1/2 NPT	1/2 NPT	

(1) H-Minimum clearance required to replace slips.
 (2) Approximate Weights (Lbs.)
 (3) Number and size tapped holes.

(4) Tapped bleeder hole.
 (5) Bottom plate drain hole.
 Dimensions "F", "G" & "J" are exact. All others are rounded off to the nearest half-inch.

(6) Dimensions are not certified.
 Contact the factory for certified drawings.
 * Reduced Round Opening